



ELM1314-9F

Ku-Band Internally Matched FET

FEATURES

- High Output Power: P1dB=39.5dBm(Typ.)
- High Gain: G1dB=6.0dB(Typ.)
- High PAE: η_{add} =30%(Typ.)
- Broad Band: 13.75 to 14.5GHz
- Impedance Matched Zin/Zout = 50ohm
- Hermetically Sealed Package

DESCRIPTION

The ELM1314-9F is a power GaAs FET that is internally matched for standard communication bands to provide optimum power and gain in a 50ohm system.

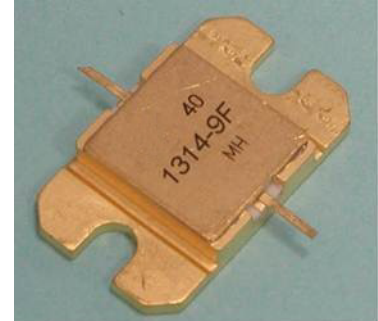

ABSOLUTE MAXIMUM RATINGS

Item	Symbol	Rating	Unit
Drain-Source Voltage (Tc=25deg.C)	V _{DS}	15	V
Gate-Source Voltage (Tc=25deg.C)	V _{GS}	-5	V
Total Power Dissipation	P _T	35.7	W
Storage Temperature	T _{stg}	-55 to +125	deg.C
Channel Temperature	T _{ch}	+175	deg.C

RECOMMENDED OPERATING CONDITION

Item	Symbol	Condition	Recommend	Unit
DC Input Voltage	V _{DS}		≤10	V
Forward Gate Current	I _{GF}	R _G =100 ohm	≤+19.5	mA
Reverse Gate Current	I _{GR}	R _G =100 ohm	≥-4.3	mA
Storage Temperature	T _{stg}		-55 to +125	deg.C
Channel Temperature	T _{ch}		≤+155	deg.C

ELECTRICAL CHARACTERISTICS (Case Temperature Tc=25deg.C)

Item	Symbol	Condition	Limit			Unit
			Min.	Typ.	Max.	
Drain Current	I _{DSS}	V _{DS} =5V, V _{GS} =0V	-	4.1	6.2	A
Trans conductance	g _m	V _{DS} =5V, I _{DS} =2A	-	2.9	-	S
Pinch-off Voltage	V _p	V _{DS} =5V, I _{DS} =175mA	-0.5	-1.5	-3.0	V
Gate-Source Breakdown Voltage	V _{GS0}	I _{GS} =-175uA	-5.0	-	-	V
Output Power at 1dB G.C.P.	P _{1dB}	V _{DS} =10V f= 13.75 to 14.5 GHz	39.0	39.5	-	dBm
Power Gain at 1dB G.C.P.	G _{1dB}		5.0	6.0	-	dB
Drain Current	I _{DSR}	I _{DS} DC=1.75A (typ.)	-	2.4	2.8	A
Power-added Efficiency	η _{add}	Z _S =Z _L =50 ohm	-	30	-	%
Gain Flatness	ΔG		-	-	1.2	dB
3rd Order Intermodulation Distortion	IM3	f=14.5 GHz Δf=10MHz, 2-tone Test P _{out} =33.0dBm (S.C.L.)	-25	-30	-	dBc
Thermal Resistance	R _{th}	Channel to Case	-	3.5	4.2	deg.C/W
Channel Temperature Rise	ΔT _{ch}	10V x I _{DSR} X R _{th}	-	-	100	deg.C

CASE STYLE : IA

S.C.L. : Single Carrier Level

G.C.P.: Gain Compression Point

ESD	Class 3A	4000V to 8000V
-----	----------	----------------

Note : Based on EIAJ ED-4701 C-111A (C=100pF, R=1.5kohm)

RoHS COMPLIANCE	Yes
-----------------	-----





ELM1314-9F

Ku-Band Internally Matched FET

POWER DERATING CURVE

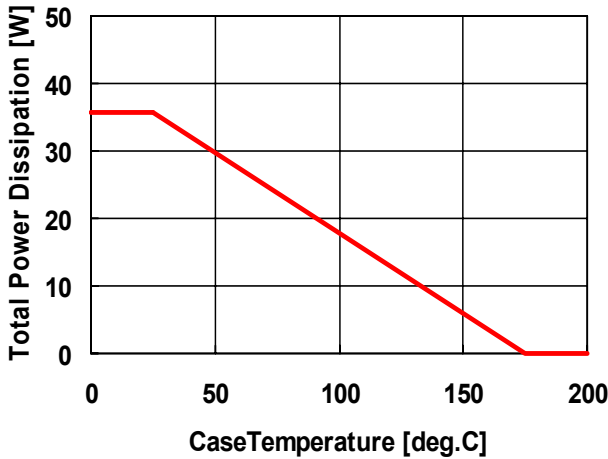

Output Power & P.A.E. vs. Input Power
 VDS=10V, IDS(DC)=1.75A, f=14.125GHz

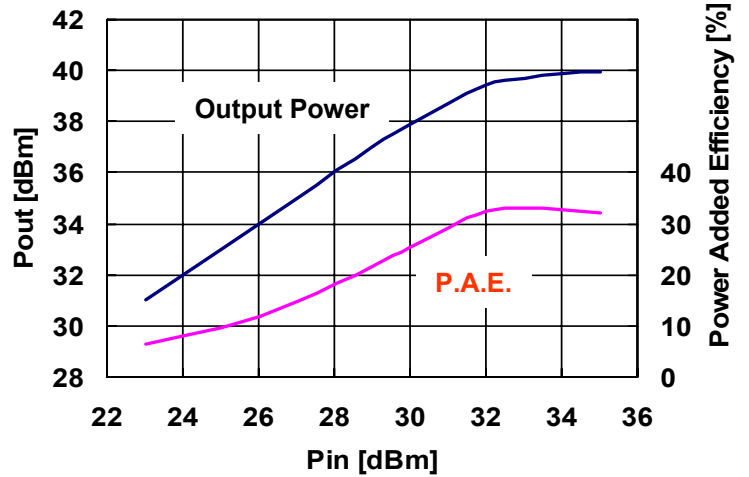

Output Power vs. frequency
 VDS=10V, IDS(DC)=1.75A

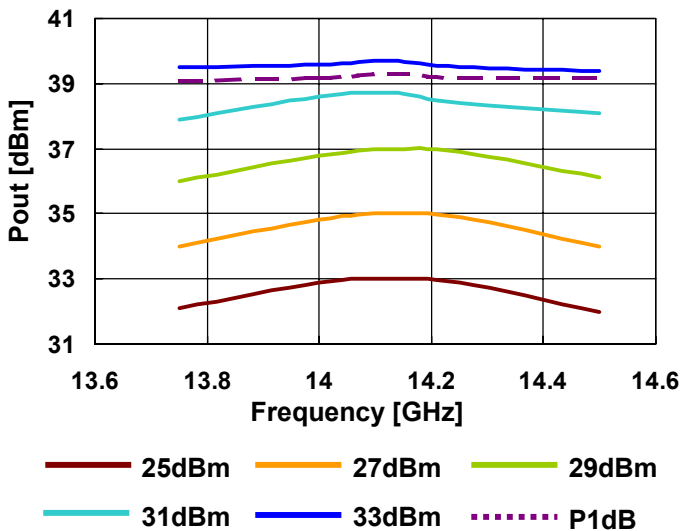

IMD vs. Output Power
 VDS=10V, IDS(DC)=1.75A
 f1=14.50 GHz, f2=14.51 GHz

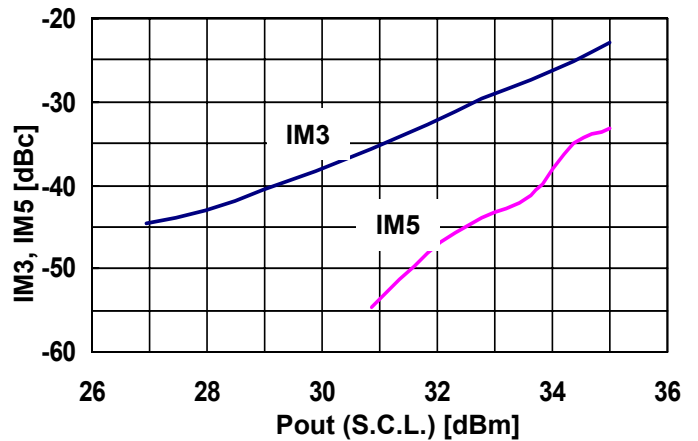



ELM1314-9F

Ku-Band Internally Matched FET

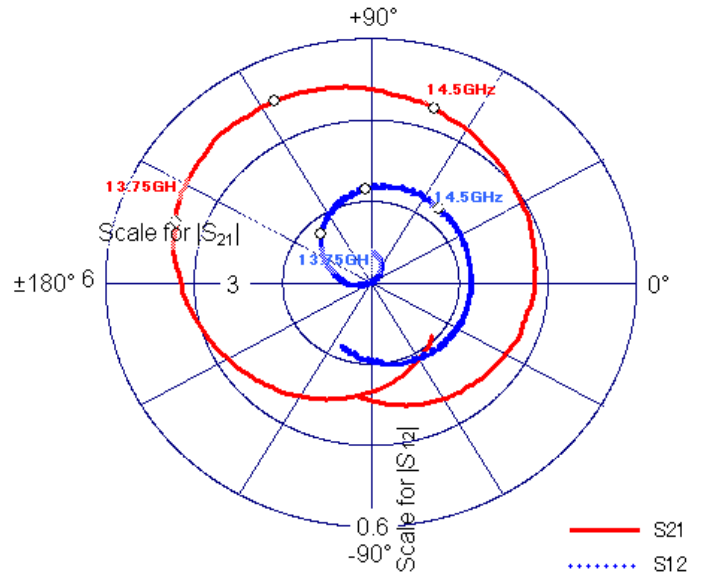
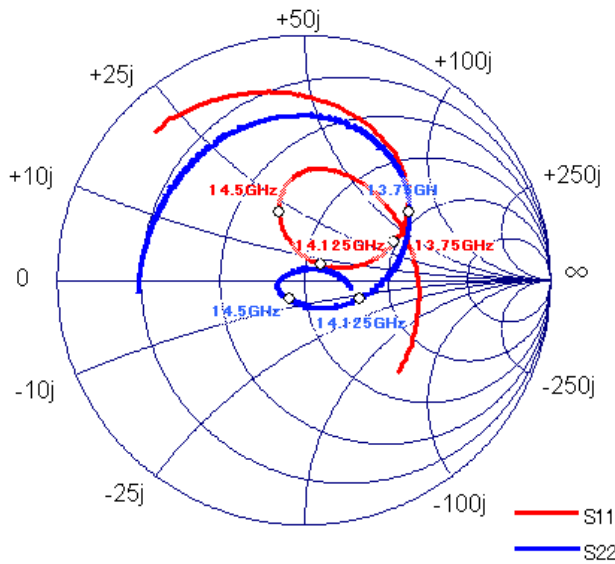

freq[GHz]	S11		S21		S12		S22	
	MAG	ANG	MAG	ANG	MAG	ANG	MAG	ANG
13.5	0.554	40.3	2.074	-171.5	0.057	154.6	0.609	54.7
13.6	0.500	33.3	2.165	178.0	0.066	146.3	0.575	46.4
13.7	0.439	26.4	2.282	166.9	0.076	137.9	0.534	37.5
13.8	0.358	20.0	2.382	155.5	0.088	128.0	0.479	27.5
13.9	0.274	15.6	2.440	143.3	0.097	118.1	0.412	15.7
14.0	0.181	17.0	2.489	130.9	0.107	106.8	0.336	2.0
14.1	0.104	35.6	2.479	118.7	0.115	95.1	0.256	-14.4
14.2	0.099	86.0	2.455	106.1	0.119	82.8	0.183	-35.4
14.3	0.163	108.6	2.407	94.2	0.121	70.9	0.129	-62.5
14.4	0.235	112.1	2.321	82.9	0.120	60.1	0.102	-96.0
14.5	0.296	109.5	2.256	71.3	0.119	50.1	0.099	-127.2
14.6	0.349	105.8	2.180	60.7	0.117	39.9	0.106	-147.3
14.7	0.391	100.9	2.089	50.6	0.116	30.6	0.112	-158.2



ELM1314-9F

Ku-Band Internally Matched FET

■ Package Out Line
Case Style : IA

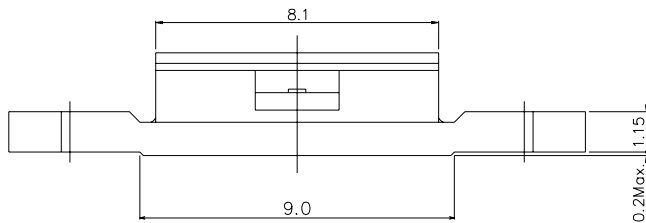
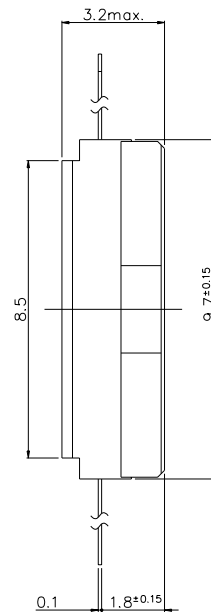
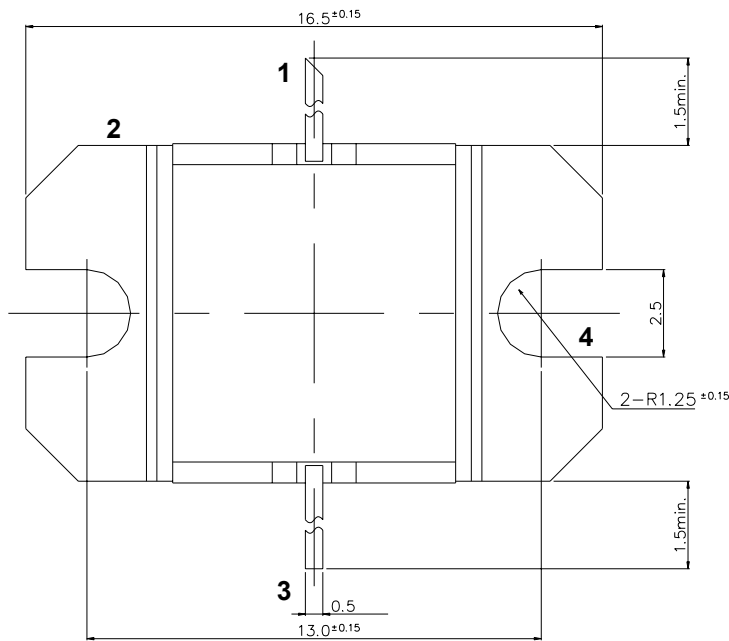

PIN ASSIGNMENT

- 1 : GATE
- 2 : SOURCE
- 3 : DRAIN
- 4 : SOURCE

Unit : mm

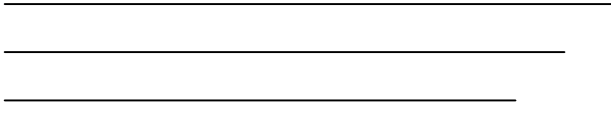

ELM1314-9F

Ku-Band Internally Matched FET

For further information please contact:

<http://global-sei.com/Electro-optic/about/office.html>

CAUTION

This product contains **gallium arsenide (GaAs)** which can be hazardous to the human body and the environment. For safety, observe the following procedures:

- Do not put these products into the mouth.
- Do not alter the form of this product into a gas, powder, or liquid through burning, crushing, or chemical processing as these by-products are dangerous to the human body if inhaled, ingested, or swallowed.
- Observe government laws and company regulations when discarding this product. This product must be discarded in accordance with methods specified by applicable hazardous waste procedures.